

SC Ni-MH 1.2V 200mAh

Application :		High Temperature Application
Nominal Voltage :		1.2V
Capacity	@0.2C @ 20°C :	2200mAh
	@0.5C @ 0°C :	1980mAh
	@0.5C @ 20°C :	2200mAh
	@0.5C @ 40°C :	23700mAh
	@0.5C @ 55°C :	1980mAh
Weight :		≤ 58g
Impedance at 1000Hz :		≤ 15mΩ
Charge	Standard :	220mA (0.1C) during 16h
	Maximum :	1100mA (0.5C) during 2.5h
	Permanent :	110mA (0.05C) during 48h
Discharge Current	Standard :	1100mA (0.5C)
	Maximum continuous :	6.6A (3C)
Temperature	During Storage :	-20°C to +45°C
	During Standard Charge :	0°C to +70°C
	During Permanent Charge :	0°C to +55°C
	During Discharge :	-20°C to +70°C

Dimensions with Tube (mm) :

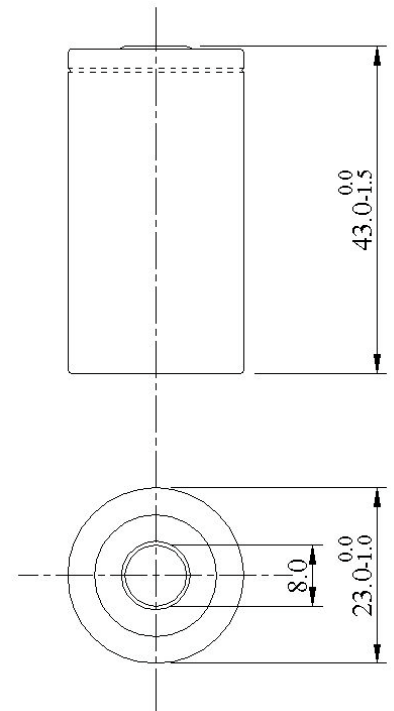

Standard Charge Characteristics

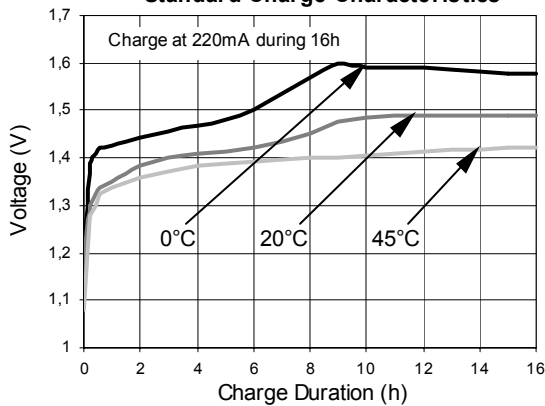

Charge Efficiency

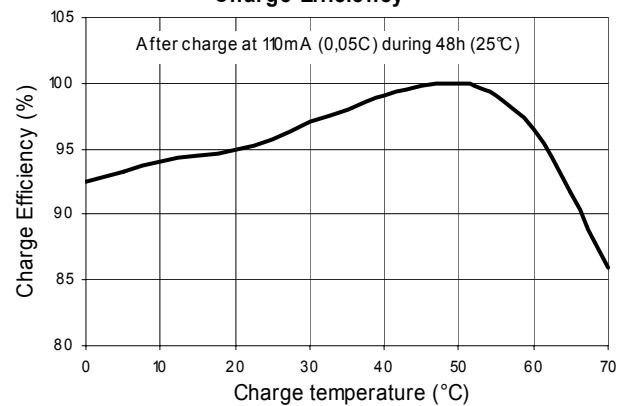

Discharge Characteristics

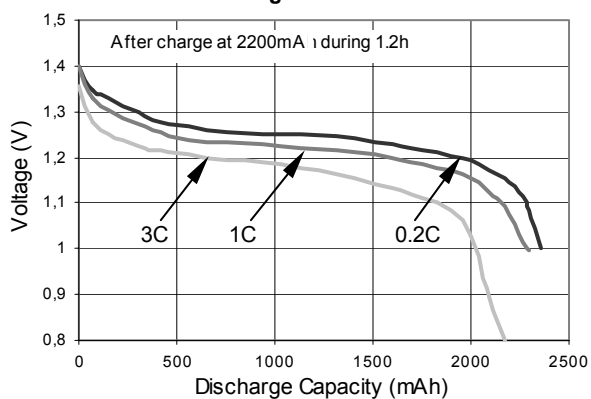

Discharge Characteristics with Temperature

